

* RoHS COMPLIANT *

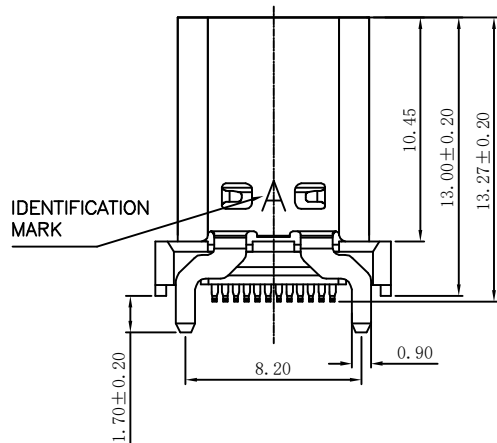
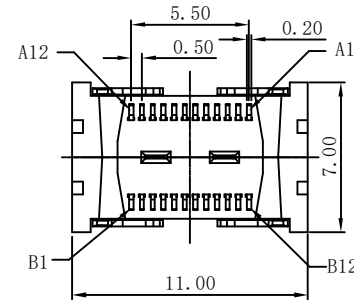
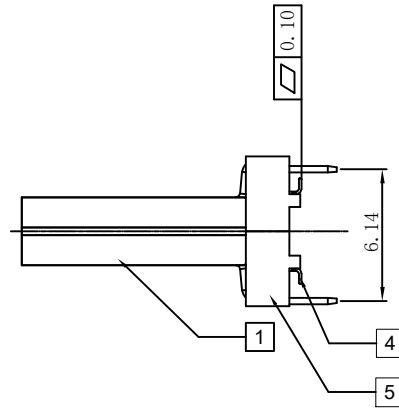
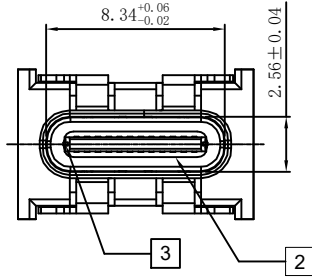
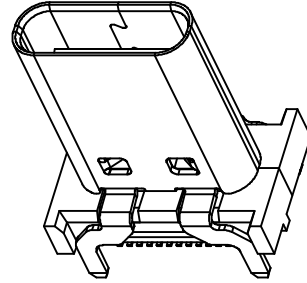
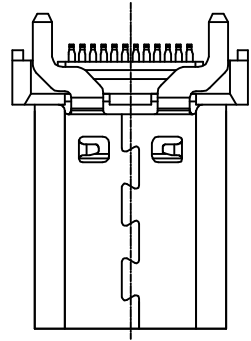

UNLESS OTHERWISE SPECIFIED, TOLERANCE ON DECIMAL: ±0.3

NOTE:

- 1.Contact Resistance:40mOHM Max.;
- 2.Dielectric Withstanding Voltage:100V AC For 1 Minute;
- 3.Insulation Resistance:100M OHM Min.;
- 4.Mating And unmating Force:
Mating Force: 5~20N
Unmating Force: 8~20N(0~1000cycle);
6~20N(1001~10000cycle);
- 5.Durability:10000 Cycles;

* REVISIONS

LTR	DESCRIPTION	DATE	REVISED	APPROVED

Item	Title	Material	Dispose	Remark
1	Shell	Stainless Steel	Ni:30u" Min.	
2	GND Plate	Stainless Steel		
3	Mid Plate	Stainless Steel	Solder Tails: Matt Tin	
4	Top Contact	Copper Alloy	Mating Area: See P/N	
5	Bottom Contact	Copper Alloy	Solder Tails: Matt Tin	
6	Insulator	High Temperature Plastic	UL 94V-0	Black

DWN	LILY	DATE	2021.03.03	3RD ANGLE PROJECTION	NAME
CHKD	ANDY	DATE	2021.03.03		TYPE C F 24PIN 直立式13mm
APVD	JON	DATE	2021.03.03		CAT. NO.
UNIT: mm					JCU-JDR-USCF031-S008
JKCR Electronics Co., Ltd.					DWN.NO.
					KQ-JDR-USCF031-S008
					002

* RoHS COMPLIANT *

CAP 示意图

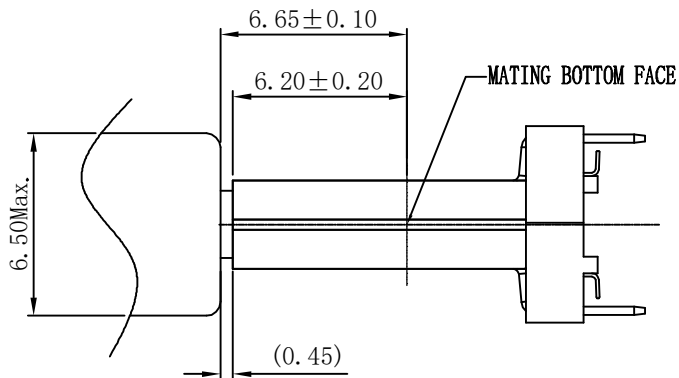
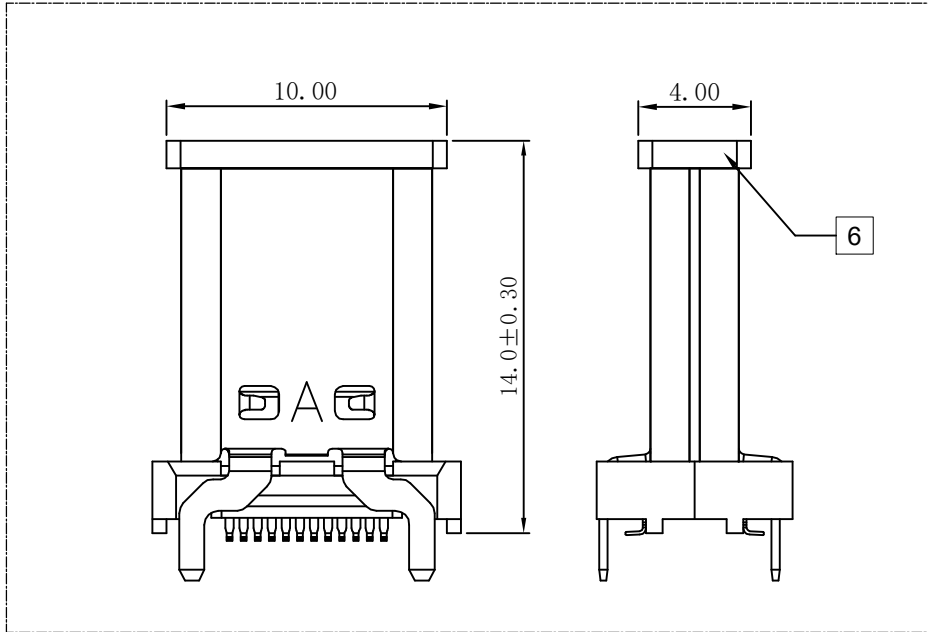

UNLESS OTHERWISE SPECIFIED, TOLERANCE ON DECIMAL: ±0.3

* REVISIONS

LTR	DESCRIPTION	DATE	REVISED	APPROVED

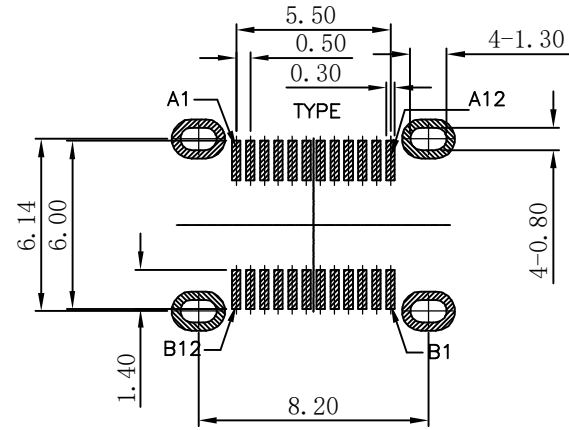

RECOMMEND P.C.B LAYOUT (COMPONENT SIDE)

TOLERANCE FOR PCB LAYOUT IS ± 0.05

KEEP OUT AREA

USB TYPE-C PIN ASSIGNMENTS

PIN NUMBER	SIGNAL NAME	PIN NUMBER	SIGNAL NAME
A1	GND	B12	GND
A2	SSTXp1	B11	SSRXp1
A3	SSTXn1	B10	SSRXn1
A4	Vbus	B9	Vbus
A5	CC1	B8	SBU2
A6	Dp1	B7	Dn2
A7	Dn1	B6	Dp2
A8	SBU1	B5	CC2
A9	Vbus	B4	Vbus
A10	SSRXn2	B3	SSTXn2
A11	SSRXp2	B2	SSTXp2
A12	GND	B1	GND

DWN	LILY	DATE	2021.03.03	3RD ANGLE PROJECTION	NAME	TYPE C F 24PIN 直立式13mm
CHKD	ANDY	DATE	2021.03.03		CAT. NO.	JCU-JDR-USCF031-S008
APVD	JON	DATE	2021.03.03	UNIT: mm	DWN.NO.	
JKCR Electronics Co., Ltd.					KQ-JDR-USCF031-S008	
					002	